

Steam



Air & Multipurpose
 General Purpose
 Heavy Duty
 Push-on

Chemical Transfer

Cleaning Equipment

Food
 Transfer
 Washdown

Marine

Material Handling
 Abrasives
 Bulk Transfer
 Cement & Concrete

Mining

Petroleum
 Aircraft Fueling
 Dispensing
 Dock
 Transfer

Spray

Steam

Vacuum

LPG Delivery

Water
 Discharge
 Suction & Discharge
 Washdown

Welding

Coupling Systems

Equipment

Appendix

	Page	Temp. Range	Smooth Cover	Wrapped Cover	Colors	Crimped Assembly
Crimped Steam Assembly	225	-40°F to 450°F	Yes	Yes	Red/Black	Yes
Flexsteel 250 CB Extreme	224	-40°F to 425°F		Yes	Red/Black	Yes
Flexsteel 250 CB Steam	223	-40°F to 425°F		Yes	Red/Black	
Flexsteel 250 EPDM-20	222	-40°F to 450°F		Yes	Red	Yes
Flexsteel 250 Steam	221	-40°F to 450°F	Yes	Yes	Red/Black	Yes
Heavy Duty Steam Pile Driver	220	-40°F to 406°F		Yes	Red/Black	
MIL-DTL-29210E Steam	228	0°F to 406°F		Yes	Black	
Plicord® 250 Steam	226	0°F to 406°F		Yes	Red/Black	

Heavy Duty Steam Pile Driver



Product Specifications

Application

Designed to withstand the toughest off-shore pile driving applications and offer long-lasting service in on shore applications. A combination of the steam-resistant EPDM tubing plus the steel aramid construction gives this hose the pliability and kinetic and crush resistance required in this application.

Construction Tube

Black EPDM synthetic rubber

Cover

Red or black EPDM synthetic rubber

Reinforcement

Brass-coated steel cord and aramid breakers

Temperature Range

-40°F to 406°F (-40°C to 205°C)

Packaging

100' exact length, coiled and polywrapped

Branding (Spiral)

Example: Continental ContiTech H.D. Steam Pile Driver 250 psi WP

Couplings

Contact fitting manufacturer for proper fitting recommendation and coupling procedure

Order Codes

541-461 (black)

541-460 (red)

Heavy Duty Steam Pile Driver

SAP #		ID		Nom. OD		Max. WP		Bend Radius		Weight	
Black	Red	in.	mm	in.	mm	psi	MPa	in.	mm	lb./ft.	kg/m
20196602		3	76.2	4.29	109.0	250	1.72	24	610	4.90	7.29
20252985	20214787	4	101.6	5.63	143.0	250	1.72	32	813	9.07	13.50
20525522		6	152.4	7.66	194.6	250	1.72	48	1200	10.98	16.4

Air & Multipurpose
General Purpose
Heavy Duty
Push-on

Chemical Transfer

Cleaning Equipment

Food
Transfer
Washdown

Marine

Material Handling
Abrasives
Bulk Transfer
Cement & Concrete

Mining

Petroleum
Aircraft Fueling
Dispensing
Dock
Transfer

Spray

Steam

Vacuum

LPG Delivery

Water
Discharge
Suction & Discharge
Washdown

Welding

Coupling Systems

Equipment

Appendix

Flexsteel® 250 Steam



Product Specifications

Application

For cleaning, heat control, fire prevention, pumping, thawing, blow-out service, steam pumps and hoists in open-end or permanent installation operations. It is used in refineries, shipyards, chemical plants, steel mills, foundries and heavy industrial applications where high strength is required and where severe environmental conditions are encountered.

Construction Tube

Pyrosyn® synthetic rubber

Cover

Black or red Pyrosyn finish, pin-pricked

Reinforcement

Braided steel wire (3/4" and 1" have 2 steel wire braids)

Temperature Range

-40°F to 450°F (-40°C to 232°C)

Packaging

Reels or 50' cut lengths (1/2" - 4 per box, 3/4" - 3 per box, 1" - 2 per box)

Branding

Example: Continental ContiTech Flexsteel® 250 Steam Max WP 250 psi. Made in U.S.A.

Couplings

See Continental ContiTech Hose Assembly Manual for most current crimp solutions.

Order Codes

539-070 (black)

539-076 (red)

539-470 (black wrapped)

539-476 (red wrapped)

Flexsteel® 250 Steam

SAP #		ID		Nom. OD		Max. WP		Weight			
Black	Red	Black Wrapped	Red Wrapped	in.	mm	in.	mm	psi	MPa	lb./ft.	kg/m
20023390	20136859	20575082	20767531	1/2	12.7	1.06	26.9	250	1.72	0.45	0.67
20023401	20023462	20757055	20757277	3/4	19.1	1.28	32.5	250	1.72	0.56	0.83
20023419	20024994	20760526	20590425	1	25.4	1.63	41.4	250	1.72	0.91	1.35
		20615488	20620044	1¼	31.8	1.88	47.8	250	1.72	1.02	1.52
		20575082	20620048	1½	38.1	2.12	53.8	250	1.72	1.23	1.830
		20617154	20620060	2	50.8	2.70	68.6	250	1.72	1.79	2.66

Air & Multipurpose

General Purpose

Heavy Duty

Push-on

Chemical Transfer

Cleaning Equipment

Food

Transfer

Washdown

Marine

Material Handling

Abrasives

Bulk Transfer

Cement & Concrete

Mining

Petroleum

Aircraft Fueling

Dispensing

Dock

Transfer

Spray

Steam

Vacuum

LPG Delivery

Water

Discharge

Suction & Discharge

Washdown

Welding

Coupling Systems

Equipment

Appendix

Flexsteel® 250 EPDM-20



Product Specifications

Application

The Flexsteel® 250 EPDM-20 features the superior performance of Flexsteel 250 Steam hose series enhanced with the increased safety factor of 20:1. This exceeds the RMA safety standard and makes steam operations more secure and user friendly. The hose has a maximum operating pressure of 250 psi with a temperature range of -40°F to 450°F.

Construction Tube

Pyrosyn® synthetic rubber

Cover

Red Wrapped Pyrosyn®, pin-pricked

Reinforcement

Braided steel wire (3/4" and larger have 2 steel wire braids)

Temperature Range

-40°F to 450°F (-40–C to 232°C)

Flexsteel® 250 EPDM-20

SAP #	ID		Nom. OD		Max. WP		Weight	
	in.	mm	in.	mm	psi	MPa	lb./ft.	kg/m
20559161	3/4	19.1	1.28	32.5	250	1.72	0.59	0.83
20736602	1	25.4	1.63	41.4	250	1.72	0.95	1.43

Packaging

Bulk, cut lengths, coupled assemblies

Branding

Example: Continental ContiTech Flexsteel® 250 EPDM-20 Steam 250 psi. Made in U.S.A.

Couplings

See Continental ContiTech Hose Assembly Manual for most current crimp solutions.

Order Codes

539-486

Air & Multipurpose
General Purpose
Heavy Duty
Push-on

Chemical Transfer

Cleaning Equipment

Food
Transfer
Washdown

Marine

Material Handling
Abrasives
Bulk Transfer
Cement & Concrete

Mining

Petroleum
Aircraft Fueling
Dispensing
Dock
Transfer

Spray

Steam

Vacuum

LPG Delivery

Water
Discharge
Suction & Discharge
Washdown

Welding

Coupling Systems

Equipment

Appendix

Flexsteel® 250 CB Steam



Product Specifications

Application

Used for cleaning, heat control, fire prevention, pumping, thawing, blowout service, steam pumps and hoists in open-end or permanent installation operations. It is used in refineries, shipyards, chemical plants, steel mills, foundries and heavy industrial applications where high strength is required and where severe environmental conditions are encountered.

Construction Tube

Chlorobutyl synthetic rubber

Cover

Red or black Pyrosyn® synthetic rubber

Reinforcement

Braided steel wire (3/4" and higher have 2 steel wire braids)

Temperature Range

-40°F to 425°F (-40°C to 218°C)

Packaging

Wrapped cover:
 1/2" - Four 50' exact length/box
 3/4"-1" - Three 50' exact length/box
 1¼"-2" - One 50' exact length/box

Branding

Example: Continental ContiTech Flexsteel® 250 CB Steam
 Max WP 250 psi. Made in U.S.A.

Couplings

Contact fitting manufacturer for proper fitting recommendation and coupling procedure.

Flexsteel® 250 CB Steam WF - Wrapped Finish

Order Codes: 1/2"-1" 539-176 (red) 1¼"-2" 581-176 (red) 1/2"-1" 539-170 (black)

SAP #	ID		Nom. OD		Max. WP		Weight			
	Red	Black	in.	mm	in.	mm	psi	MPa	lb./ft.	kg/m
20050829			1/2	12.7	1.00	25.4	250	1.72	0.40	0.60
20024094	20050195		3/4	19.1	1.31	33.3	250	1.72	0.64	0.95
20045991			1	25.4	1.56	39.6	250	1.72	0.77	1.15
20045770			1¼	31.8	1.75	44.5	250	1.72	1.06	1.58
20046224			1½	38.1	2.00	50.8	250	1.72	1.42	2.11
20046225			2	50.8	2.50	63.5	250	1.72	1.71	2.54

Air & Multipurpose

General Purpose

Heavy Duty

Push-on

Chemical Transfer

Cleaning Equipment

Food

Transfer

Washdown

Marine

Material Handling

Abrasives

Bulk Transfer

Cement & Concrete

Mining

Petroleum

Aircraft Fueling

Dispensing

Dock

Transfer

Spray

Steam

Vacuum

LPG Delivery

Water

Discharge

Suction & Discharge

Washdown

Welding

Coupling Systems

Equipment

Appendix

Flexsteel® 250 CB Extreme Crimp Steam Hose



Product Specifications

Application

ContiTech is pleased to announce the Flexsteel® 250 CB Extreme Crimp Steam Hose, the only ContiTech chlorobutyl steam hose with an enhanced over-the-cover crimp coupling solution. The hose is rated to a maximum operating pressure of 250 psi, and its temperature range is -40°F to 425°F (-40°C to 218°C), up to 450°F intermittent, with a 10:1 safety factor. And it is the only ContiTech chlorobutyl steam hose with a crimp solution.

Construction Tube

Chlorobutyl synthetic rubber

Cover

Red or black Pyrosyn®, pin-pricked

Temperature Range

-40°F to 425°F (-40°C to 218°C), up to 450°F intermittent

Packaging

Reels, cut lengths and coupled assemblies

Branding

Example: Continental ContiTech Flexsteel® 250 CB Extreme Crimp Steam. Drain after using. Made in U.S.A.

Material Code

539-870-024 (black)

539-876-024 (red)

Flexsteel 250 CB Extreme Crimp Steam Hose

SAP #		ID		OD		Max. WP		Weight	
Black	Red	in.	mm	in.	mm	psi	MPa	lb./ft.	kg/m
20637404	20645689	3/4	19.1	1.28	32.5	250	1.72	250	1.72

Hose ID	Cambell Ground Joint Viton Sea Setting Low Profile Nut	Cambell Ground Joint Viton Seal Female NPT Spud Wing Nut	Cambell Male NPT	Cambell Male Male NPT Swivel	Crimp Diameter	Die Set	Approx. Setting
3/4	RGJF-3V	GJF-3V	IMS-3V	IMS-3VSW	1.43	36	0.32

Air & Multipurpose
General Purpose
Heavy Duty
Push-on

Chemical Transfer

Cleaning Equipment

Food
Transfer
Washdown

Marine

Material Handling
Abrasives
Bulk Transfer
Cement & Concrete

Mining

Petroleum
Aircraft Fueling
Dispensing
Dock
Transfer

Spray

Steam

Vacuum

LPG Delivery

Water
Discharge
Suction & Discharge
Washdown

Welding

Coupling Systems

Equipment

Appendix

Crimped Steam Assembly



Product Specifications

Application

Coupling assembly crimps permanently onto hose; forms a tight crimp that reduces leaks and eliminates bulky bolt clamps while reducing potential for damage from snagging on personnel or property.

Recommended Crimp Diameters for Continental ContiTech Branded Steam Hose

Hose Description	Hose Product Code	Hose ID	Female Ground Joint Low Profile Unit	Female Ground Joint Wing Nut	Male NPT	Male NPT Swivel	Female Spud	Crimp Dia.	Continental ContiTech Perma-Crimp	Approx. Die Set	Approx. Setting
Flexsteel 250 (Black)	539-070-024	3/4"	RGJS-3V	GJS-3V	IMS-3V	IMS-3VSW	GFS-3	1.440"	34	2.6	
Flexsteel 250 (Red)	539-076-024	3/4"	RGJS-3V	GJS-3V	IMS-3V	IMS-3VSW	GFS-3	1.440"	34	2.6	
Flexsteel 250 (Black)	539-070-032	1"	RGJS-4V	GJS-4V	IMS-4V	IMS-4VSW	GFS-4	1.925"	45	3.9	
Flexsteel 250 (Red)*	539-076-032	1"	RGN-4*	GN-4*	IMS-4G*	N/A	GFS-4	1.660**	41	1.16	
Flexsteel 250 (Red Wrapped)	536-476-024	3/4"	RGJS-3V	GJS-3V	IMS-3V	IMS-3VSW	GFS-3	1.440"	34	2.6	
Flexsteel 250 CB Extreme (Black, Red)	539-870-024										
	539-876-024	3/4"	RGJF-3V	GJF-3V	IMS-3V	IMS-3VSW	GFS-3	1.430"	34	2.32	
Flexsteel 250 EPDM 20 (Red)	539-486-024	3/4"	RGJS-3V	GJS-3V	IMS-3V	IMS-3VSW	GFS-3	1.420"	34	2.1	

*For the 2-piece skived fitting solution with SCF-4G ferrule, use GJS-4G NC stem for ground joint fittings. Skive length 1.555".

Female Wing Nut



Female Wing Nut with Female NPT Spud

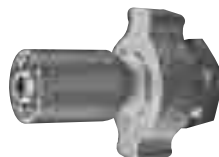

Male NPT Swivel



Available as Male NPT

Female Low Profile Nut with Female NPT Spud



Air & Multipurpose

General Purpose

Heavy Duty

Push-on

Chemical Transfer

Cleaning Equipment

Food

Transfer

Washdown

Marine

Material Handling

Abrasives

Bulk Transfer

Cement & Concrete

Mining

Petroleum

Aircraft Fueling

Dispensing

Dock

Transfer

Spray

Steam

Vacuum

LPG Delivery

Water

Discharge

Suction & Discharge

Washdown

Welding

Coupling Systems

Equipment

Appendix

Plicord® 250 Steam



Product Specifications

Application

A rugged construction used for all-around steam service in chemical plants, refineries, shipyards and demanding industrial service. It is recommended for cleaning, thawing, blowout service, steam pumps, hoists and other applications involving steam.

Construction Tube

Black EPDM synthetic rubber

Cover

Black EPDM synthetic rubber, also available in red cover with yellow brand for color coding (wrapped impression)

Reinforcement

Spiral-plied steel wire

Temperature Range

0°F to 406°F (-18°C to 208°C)

Packaging

50' lengths, coiled and polywrapped

Branding (Spiral)

Example: Continental ContiTech Plicord® 250 Steam psi.
Drain after use

Couplings

Contact fitting manufacturer for proper fitting recommendation and coupling procedure.

Order Codes

549-060 (black)
549-061 (red)

Plicord® 250 Steam

SAP#		ID		Nom. OD		Max. WP		Weight	
Black	Red	in.	mm	in.	mm	psi	MPa	lb./ft.	kg/m
20019132	20019162	1/2	12.7	0.97	24.6	250	1.72	0.33	0.49
20019137	20019168	3/4	19.1	1.25	31.8	250	1.72	0.49	0.73
20019141	20019174	1	25.4	1.50	38.1	250	1.72	0.61	0.91
20019144	20019178	1¼	31.8	1.81	46.0	250	1.72	0.83	1.24
20019148	20019180	1½	38.1	2.09	53.1	250	1.72	1.03	1.53
20019154	20019184	2	50.8	2.78	70.6	250	1.72	1.88	2.80
20019155	20019186	2½	63.5	3.28	83.3	250	1.72	2.33	3.47
20019158	20019187	3	76.2	3.77	95.8	250	1.72	2.73	4.06

Air & Multipurpose
General Purpose
Heavy Duty
Push-on

Chemical Transfer

Cleaning Equipment

Food
Transfer
Washdown

Marine

Material Handling
Abrasives
Bulk Transfer
Cement & Concrete

Mining

Petroleum
Aircraft Fueling
Dispensing
Dock
Transfer

Spray

Steam

Vacuum

LPG Delivery

Water
Discharge
Suction & Discharge
Washdown

Welding

Coupling Systems

Equipment

Appendix

Hydrocarbon Drain Hose®



Product Specifications

Application

Heavy Duty hose designed for use in hydrocarbon drain service.

Couplings

Contact fitting manufacturer for proper fitting recommendation and coupling procedure

Construction Tube

Black Nitrile

Order Code

543-729

Cover

Blue Wingprene

Reinforcement

Spiral Piled two steel wires

Temperature Range

-25°F to 350°F (-32°C to 177°C)

Packaging

100' Lengths, coiled and polywrapped

Branding

Continental ContiTech Hydrocarbon Drain Hose 300 PSI

Hydrocarbon Drain Hose®

SAP#	ID		OD		Max. WP	Weight
	in.	mm	in.	mm	psi	lb./ft.
20264356	3/4	19.1	1.33	33.86	300	0.63
20467694	1	25.4	1.58	40.14	300	0.78
20326679	1 1/2	38.1	2.25	57.2	300	1.57
20276441	2	50.8	2.77	70.36	300	2.01

Air & Multipurpose

General Purpose

Heavy Duty

Push-on

Chemical Transfer

Cleaning Equipment

Food

Transfer

Washdown

Marine

Material Handling

Abrasives

Bulk Transfer

Cement & Concrete

Mining

Petroleum

Aircraft Fueling

Dispensing

Dock

Transfer

Spray

Steam

Vacuum

LPG Delivery

Water

Discharge

Suction & Discharge

Washdown

Welding

Coupling Systems

Equipment

Appendix

MIL-DTL-29210E Steam Hose

Updates to new “E” Specification



Product Specifications

Application

Hose assembly for military applications (such as Navy shipyard use) in temporary services from docks or barges to ships. First Article-approved hose meeting the requirements of MIL-DTL-29210 rev. E. This specification covers metal-lined, wire-reinforced, rubber hose assemblies for conveyance of saturated steam.*

Revision E update (key changes):

- › Ozone and steam tests as part of conformance testing are required for 1st Article in rev. E
- › Part or identifying number (PIN) is much more specific
- › The branding requirements have been corrected to brand as MIL-DTL-29210 instead of MIL-PRF-29210C.

Construction Tube

EPDM

Cover

Black wrapped finish EPDM

Reinforcement

2 wire braids

MIL-DTL-29210E Steam Hose

SAP #	ID		Nom. OD		Max. WP		Weight	
	in.	mm	in.	mm	psi	MPa	lb./ft.	kg/m
20490435	3/4	19.05	1.315	33.40	250	1.723	0.61	0.91
20453479	1	25.4	1.61	40.89	250	1.723	0.82	1.22
20469264	1½	38.1	2.12	53.85	250	1.723	1.22	1.82
20458670	2	50.8	2.71	68.83	250	1.723	1.80	2.68

*Steel liners are not available through Continental ContiTech. Please refer to Mil Spec for approved suppliers list.

Temperature Range

0° to 406°F (-18°C to 208°C)

Packaging

25' or 50' cut lengths

Branding

Continental ContiTech (Quarter/Year Date Code)
MIL-DTL-29210 250 PSIG (1724 KPA {Gauge}) steam 29210E

Couplings

End fittings and special stem design per MIL-DTL-29210E for use with stainless-steel metal liner.* Stainless-steel metal liner per MIL-DTL-29210E

Non Stock/Sizes

¾", 1", 1¼", 1½", 2" (*in development)

Order Codes

539-670

Air & Multipurpose
General Purpose
Heavy Duty
Push-on

Chemical Transfer

Cleaning Equipment

Food
Transfer
Washdown

Marine

Material Handling
Abrasives
Bulk Transfer
Cement & Concrete

Mining

Petroleum
Aircraft Fueling
Dispensing
Dock
Transfer

Spray

Steam

Vacuum

LPG Delivery

Water
Discharge
Suction & Discharge
Washdown

Welding

Coupling Systems

Equipment

Appendix