



PREFORMED BAND CLAMPS



BAND-IT®

All band clamps, banding, tools and accessories are genuine Band-It products. Ultra-Lok® and Jr® are registered trademarks of Band-It®.

ULTRA-LOK® CLAMPS

Ultra-Lok® Clamps are manufactured from 201 Stainless Steel. The buckle is thicker and stronger than standard band clamps for superior holding strength. The powerful Ultra-Lok® Tool is portable which enables the operator to bring the tool to the hose, instead of the hose to the tool, for much easier assembly.

JR®-TYPE PREFORMED CLAMPS

Jr®-type preformed clamps are available in both galvanized carbon steel and 201 stainless steel. All buckles are stainless steel.

Jr® clamps are designed for use with high production air tools, or the C001 Banding Tool.

PUNCH-TYPE PREFORMED CLAMPS

Punch type preformed clamps are available in galvanized carbon steel and 201 stainless steel. All buckles are stainless steel.

Punch clamps are designed for use with the punch style tool for the ultimate in field serviceability.

BANDING AND BUCKLES



Banding is cartoned in 100 foot rolls and available in 201 stainless steel. Buckles, sold separately, are 201 stainless steel. Banding features specially rolled edges to reduce the possibility of injury. Use the C001 Banding Tool to install.

WORM GEAR CLAMPS

Worm gear clamps are available in standard 1/2" band, miniature 5/16" band and quick release 1/2" band. All are manufactured with stainless steel band and stainless steel housing, with your choice of a carbon steel or stainless steel screw.



T-BOLT CLAMPS

T-Bolt clamps provide 360 degrees of sealing surface, and are particularly useful for high torque applications.



BAND CLAMPS, BANDING, AND BUCKLES

ULTRA-LOCK® SMOOTH I.D. CLAMPS

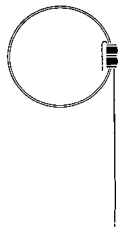

Band: 201 Stainless
Buckle: 201 Stainless

clamp width	clamp id.	part number	list/100	carton qty.
3/4	2	UL227	803.15	100
3/4	2-3/4	UL210	875.36	50
3/4	3	UL211	948.16	50
3/4	3-1/2	UL212	1009.10	50
3/4	4	UL213	1158.43	25
3/4	4-1/2	UL214	1243.08	25
3/4	5	UL215	1344.10	25
3/4	5-1/2	UL270	1394.86	25
3/4	6	UL216	1545.74	25
3/4	6-1/2	UL217	1703.06	25
3/4	7	UL218	1860.12	25
3/4	8	UL219	2094.22	25
3/4	9	UL228	2344.63	10

JR®-TYPE PREFORMED-SMOOTH I.D.

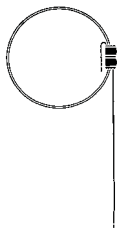

Band: Galvanized Steel
Buckle: 201 Stainless

clamp width	clamp id.	part number	list/100	carton qty.
3/8	13/16	JS301	110.90	100
3/8	1	JS343	115.64	100
3/8	1-3/8	JS302	122.01	100
3/8	2	JS345	151.33	100
3/8	2-1/2	JS321	223.64	100
3/8	3	JS346	195.20	100
3/8	3-1/2	JS355	280.59	100
3/8	4	JS348	308.32	100
1/2	1	JS303	154.61	100
1/2	1-1/4	JS304	170.20	100
1/2	1-1/2	JS331	192.40	100
1/2	1-3/4	JS336	224.70	100
1/2	2	JS337	233.08	100
1/2	2-1/2	JS333	247.25	100
1/2	2-3/4	JS330	268.19	100
1/2	3	JS334	297.27	100
1/2	3-1/2	JS347	334.96	100
1/2	4	JS349	376.55	100

5/8	1-1/2	JS305	200.84	100
5/8	1-3/4	JS306	222.35	100
5/8	2	JS307	243.55	100
5/8	2-1/4	JS308	259.07	100
5/8	2-1/2	JS309	280.11	100
3/4	2	JS327	297.98	100
3/4	2-3/4	JS310	334.48	50
3/4	3	JS311	352.77	50
3/4	3-1/2	JS312	380.67	50
3/4	4	JS313	440.13	25
3/4	4-1/2	JS314	464.48	25
3/4	5	JS315	508.16	25
3/4	5-1/4	JS370	625.28	25
3/4	6	JS316	584.18	25
3/4	7	JS318	692.92	25
3/4	8	JS319	984.49	25

Band: 201 Stainless
Buckle: 201 Stainless

clamp width	clamp id.	part number	list/100	carton qty.
1/4	13-16	JS240	277.59	100
1/4	1	JS242	278.79	100
1/4	1-3/8	JS241	304.14	100
1/4	1-1/2	JS252	301.88	100
1/4	2	JS253	338.21	100
1/4	2-1/2	JS220	376.00	100
1/4	2-3/4	JS256	403.02	100
1/4	3	JS244	399.13	100
1/4	3-12	JS257	428.47	100
1/4	4	JS258	519.08	100
1/4	4-1/2	JS259	611.65	100
3/8	13/16	JS201	287.42	100
3/8	1	JS243	330.68	100
3/8	1-3/8	JS202	323.72	100
3/8	2	JS245	366.46	100
3/8	2-1/2	JS221	417.36	100
3/8	3	JS246	469.64	100
3/8	3-1/2	JS255	577.38	100
3/8	4	JS248	555.90	100
1/2	1	JS203	400.51	100
1/2	1-1/4	JS204	441.71	100
1/2	1-1/2	JS231	508.42	100
1/2	1-3/4	JS236	576.67	100
1/2	2	JS237	605.18	100
1/2	2-1/2	JS233	634.94	100
1/2	2-3/4	JS230	666.28	100
1/2	3	JS234	736.95	100
1/2	3-1/2	JS247	809.20	100
1/2	4	JS249	883.35	100
5/8	1-1/2	JS205	531.38	100
5/8	1-3/4	JS206	587.43	100
5/8	2	JS207	643.99	100
5/8	2-1/4	JS208	684.84	100
5/8	2-1/2	JS209	730.87	100
3/4	2	JS227	795.45	100
3/4	2-3/4	JS210	866.99	50
3/4	3	JS211	939.08	50
3/4	3-1/2	JS212	999.50	50
3/4	4	JS213	1147.09	25
3/4	4-1/2	JS214	1230.97	25
3/4	5	JS215	1331.08	25
3/4	5-1/4	JS270	1381.46	25
3/4	6	JS216	1531.31	25
3/4	7	JS218	1842.46	25
3/4	8	JS219	2074.51	25

PUNCH-TYPE PREFORMED

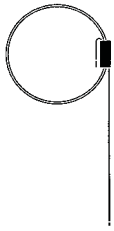

Band: Galvanized Steel
Buckle: 201 Stainless

clamp width	clamp id.	part number	list/100	carton qty
3/8	13/16	CP3	77.74	100
3/8	1-3/8	CP311	92.25	100
5/8	1	CP4	96.29	100
5/8	1-1/4	CP5	101.70	100
5/8	1-1/2	CP6	108.70	100
5/8	1-3/4	CP7	118.90	100
5/8	2	CP8	127.12	100
5/8	2-1/4	CP9	135.38	100
5/8	2-1/2	CP10	163.49	50
5/8	2-3/4	CP11	170.94	50
5/8	3	CP12	181.57	50
5/8	3-1/2	CP14	193.89	50
5/8	4	CP16	223.54	25
5/8	4-1/2	CP18	236.05	25
5/8	5	CP20	248.93	25
5/8	6	CP24	270.95	25
5/8	7	CP28	312.73	25
5/8	8	CP32	438.19	25

Band: 201 Stainless
Buckle: 201 Stainless

3/8	13/16	CP3-S	192.26	100
3/8	1-3/8	CP311-S	220.54	100
5/8	1	CP4-S	291.96	100
5/8	1-1/4	CP5-S	306.94	100
5/8	1-1/2	CP6-S	325.86	100
5/8	1-3/4	CP7-S	357.42	100
5/8	2	CP8-S	377.68	100
5/8	2-1/4	CP9-S	402.70	100
5/8	2-1/2	CP10-S	436.38	50
5/8	2-3/4	CP11-S	462.09	50
5/8	3	CP12-S	482.98	50
5/8	3-1/2	CP14-S	533.26	50
5/8	4	CP16-S	605.31	25
5/8	4-1/2	CP18-S	651.72	25
5/8	5	CP20-S	700.63	25
5/8	6	CP24-S	791.45	25
5/8	7	CP28-S	942.18	25
5/8	8	CP32-S	1030.25	25

I.D. TIE-LOK TIES



304 Stainless

width in.	length in.	part number	list/100	carton qty.
1/4	10	AS211	249.34	100
1/4	16-1/2	AS212	326.62	100
1/4	22-1/2	AS213	404.67	100
1/4	29	AS214	484.84	100
1/4	35	AS215	557.28	100

I.D. TAGS



304 Stainless

width in.	length in.	part number	list/100	carton qty.
3/4	2	ID100	190.27	100
1-1/2	2-1/2	ID101	260.55	100
3/4	3-1/2	ID102	250.09	100

ULTRA-LOK ELECTRIC INSTALLATION TOOL

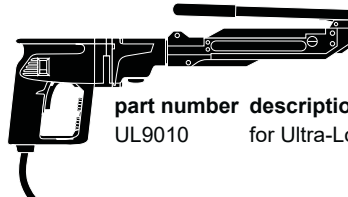

part number	description	list each
UL9010	for Ultra-Lok Preformed Clamps	POR

STANDARD AIR TOOL & COMPONENTS

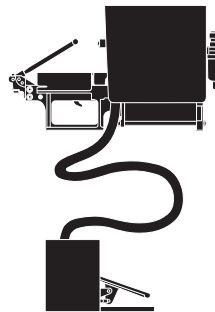

part number	description	list each
S750	with S180 head	POR

CENTER PUNCH TOOLS & ACCESSORIES

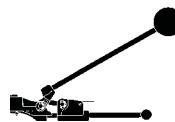

part number	description	list each
T300	for 5/8" wide clamps	POR

COMPACT TOOL SET



part number	list each
S38	POR

BAND TOOL

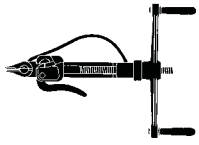

part number	list each
C001	POR

BAND TOOL ADAPTER



part number	description	list each
J001	Jr adapter	POR
J050	heavy duty adapter	POR

TIE-LOK TOOL



part number	list each
A920	POR

BAND



304 Stainless

band width	part number	list/ 100ft.	carton qty.
1/4	C202	129.78	100 ft.
3/8	C203	169.04	100 ft.
1/2	C204	228.47	100 ft.
5/8	C205	276.50	100 ft.
3/4	C206	340.98	100 ft.

BUCKLES

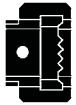

201 Stainless Steel

band width	part number	list/ 100	carton qty.
1/4	C252	105.52	100
3/8	C253	116.60	100
1/2	C254	157.67	100
5/8	C255	196.97	100
3/4	C256	238.17	100

WORM GEAR CLAMPS



**STANDARD WORM GEAR
(5/16" screw, 1/2" band)**

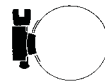

**Screw: Galvanized Steel
Band: 301 Stainless Steel**

size range	part number	list/ 100	carton qty.
3/8 X 7/8	WGCS-6	150.00	10
7/16 X 1	WGCS-8	150.00	10
9/16 X 1-1/16	WGCS-10	150.00	10
9/16 X 1-1/4	WGCS-12	155.00	10
11/16 X 1-1/2	WGCS-16	155.00	10
3/4 X 1-3/4	WGCS-20	155.00	10
1-1/16 X 2	WGCS-24	155.00	10
1-5/16 X 2-1/4	WGCS-28	160.00	10
1-9/16 X 2-1/2	WGCS-32	160.00	10
1-13/16 X 2-3/4	WGCS-36	165.00	10
2-1/16 X 3	WGCS-40	200.00	10
2-15/16 X 3-1/4	WGCS-44	220.00	10
2-9/16 X 3-1/2	WGCS-48	220.00	10
2-13/16 X 3-3/4	WGCS-52	240.00	10
3-1/16 X 4	WGCS-56	240.00	10
3-5/16 X 4-1/4	WGCS-60	250.00	10
3-9/16 X 4-1/2	WGCS-64	275.00	10
4-1/16 X 5	WGCS-72	292.00	10
4-5/8 X 5-1/2	WGCS-80	338.00	10
4-3/32 X 6	WGCS-88	344.00	10
4-1/2 X 6-1/2	WGCS-96	350.00	10
5 X 7	WGCS-104	355.00	10
6-1/2 X 8-1/2	WGCS-128	479.00	10
8 X 10	WGCS-152	514.00	10
10-1/4 X 12-1/4	WGCS-188	575.00	10
11 X 13	WGCS-200	580.00	10
11-3/4 X 13-3/4	WGCS-212	590.00	10
12-1/2 X 14-1/2	WGCS-224	655.00	10
14 X 16	WGCS-248	745.00	10
15-3/8 X 17-3/8	WGCS-270	857.00	10
18 X 20	WGCS-312	910.00	10
19-1/8 X 21-1/4	WGCS-332	1003.00	10
22-7/8 X 24-7/8	WGCS-390	1015.00	10

continued on next page

STANDARD WORM GEAR (continued from previous page)

Screw: 305 Stainless Steel
Band: 301 Stainless Steel

size range	part number	list/100	carton qty
3/8 X 7/8	WGSS-6	200.00	10
7/16 X 1	WGSS-8	200.00	10
9/16 X 1-1/16	WGSS-10	200.00	10
9/16 X 1-1/4	WGSS-12	200.00	10
11/16 X 1-1/2	WGSS-16	200.00	10
3/4 X 1-3/4	WGSS-20	205.00	10
1-1/16 X 2	WGSS-24	205.00	10
1-5/16 X 2-1/4	WGSS-28	205.00	10
1-9/16 X 2-1/2	WGSS-32	205.00	10
1-13/16 X 2-3/4	WGSS-36	215.00	10
2-1/16 X 3	WGSS-40	245.00	10
2-15/16 X 3-1/4	WGSS-44	280.00	10
2-9/16 X 3-1/2	WGSS-48	280.00	10
2-13/16 X 3-3/4	WGSS-52	295.00	10
3-1/16 X 4	WGSS-56	295.00	10
3-5/16 X 4-1/4	WGSS-60	300.00	10
3-9/16 X 4-1/2	WGSS-64	300.00	10
4-1/16 X 5	WGSS-72	330.00	10
4-5/8 X 5-1/2	WGSS-80	340.00	10
4-3/32 X 6	WGSS-88	375.00	10
4-1/2 X 6-1/2	WGSS-96	385.00	10
5 X 7	WGSS-104	335.00	10
6-1/2 X 8-1/2	WGSS-128	525.00	10
8 X 10	WGSS-152	580.00	10
10-1/4 X 12-1/4	WGSS-188	635.00	10
11 X 13	WGSS-200	680.00	10
11-3/4 X 13-3/4	WGSS-212	715.00	10
12-1/2 X 14-1/2	WGSS-224	760.00	10
14 X 16	WGSS-248	940.00	10
15-3/8 X 17-3/8	WGSS-270	1109.00	10
18 X 20	WGSS-312	1075.00	10

size range	part number	list each	bag qty
2.09 X 2.31	TBCS-33	8.36	10
2.33 X 2.62	TBCS-37	8.36	10
2.40 X 2.69	TBCS-38	8.14	10
2.52 X 2.81	TBCS-41	8.14	10
2.77 X 3.06	TBCS-43	8.25	10
2.87 X 3.18	TBCS-45	8.25	10
3.02 X 3.31	TBCS-47	8.36	10
3.27 X 3.56	TBCS-49	8.36	10
3.39 X 3.68	TBCS-53	8.69	10
3.59 X 3.88	TBCS-58	8.80	10
3.77 X 4.06	TBCS-61	8.80	10
4.02 X 4.31	TBCS-65	8.80	10
4.27 X 4.56	TBCS-69	8.80	10
4.52 X 4.81	TBCS-73	8.80	10
4.77 X 5.06	TBCS-77	8.91	10
5.02 X 5.31	TBCS-81	8.91	10
5.27 X 5.56	TBCS-85	9.46	10
5.52 X 5.81	TBCS-89	9.46	10
5.77 X 6.06	TBCS-93	9.57	10
6.02 X 6.31	TBCS-97	9.57	10
6.27 X 6.56	TBCS-101	9.68	10
6.52 X 6.81	TBCS-105	9.68	10
7.27 X 7.56	TBCS-113	9.79	10
7.27 X 7.56	TBCS-117	11.17	10
7.50 X 7.81	TBCS-121	11.17	10
7.77 X 8.06	TBCS-125	11.17	10
8.02 X 8.31	TBCS-129	11.17	10
8.77 X 9.06	TBCS-139	12.02	10
10.65 X 10.94	TBCS-170	13.37	10
12.65 X 12.94	TBCS-202	13.73	10

Bolt & Trunion: Stainless Steel
Band: Stainless Steel

size range	part number	list each	bag qty
1.34 X 1.56	TBSS-21	9.57	10
1.59 X 1.81	TBSS-25	9.57	10
1.72 X 1.94	TBSS-27	9.57	10
1.84 X 2.06	TBSS-29	9.68	10
2.09 X 2.31	TBSS-33	9.68	10
2.22 X 2.44	TBSS-35	9.68	10
2.34 X 2.56	TBSS-37	9.35	10
2.40 X 2.69	TBSS-38	9.35	10
2.52 X 2.81	TBSS-39	9.35	10
2.65 X 2.94	TBSS-41	9.35	10
2.65 X 2.94	TBSS-43	9.46	10
2.87 X 3.18	TBSS-45	9.46	10
2.87 X 3.18	TBSS-47	9.46	10
3.02 X 3.31	TBSS-49	9.79	10
3.27 X 3.56	TBSS-53	9.79	10
3.59 X 3.88	TBSS-58	9.79	10
4.02 X 4.31	TBSS-65	9.90	10
4.27 X 4.56	TBSS-69	9.90	10
4.52 X 4.81	TBSS-73	10.56	10
4.77 X 5.06	TBSS-77	10.78	10
5.02 X 5.31	TBSS-81	10.78	10
5.27 X 5.56	TBSS-85	11.33	10
5.77 X 6.06	TBSS-93	11.33	10
6.27 X 6.56	TBSS-101	11.33	10
6.52 X 6.81	TBSS-105	11.33	10
6.77 X 7.06	TBSS-109	11.77	10
7.02 X 7.31	TBSS-113	11.88	10
7.27 X 7.56	TBSS-117	11.88	10
7.50 X 7.81	TBSS-121	11.88	10
7.02 X 8.31	TBSS-125	12.21	10
8.77 X 9.06	TBSS-129	12.21	10
10.65 X 10.94	TBSS-170	13.97	10
12.65 X 12.94	TBSS-202	13.97	10



T-BOLT CLAMPS



Bolt & Trunion: Galvanized Steel
Band: Stainless Steel

size range	part number	list each	bag qty
1.34 X 1.56	TBCS-21	8.36	10
1.59 X 1.81	TBCS-25	8.36	10
1.72 X 1.94	TBCS-27	8.36	10
1.84 X 2.06	TBCS-29	8.36	10

IMPORTED CLAMPS

DOUBLE BOLT CLAMPS

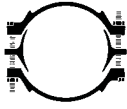

Ductile Iron

hose o.d. min.	hose o.d. max.	part number	list each
7/8	1-1/8	SL-29	3.23
1-3/16	1-5/16	SL-34	3.45
1-5/16	1-17/32	SL-40	4.64
1-3/4	1-31/32	SL-49	6.42
2-3/16	2-9/16	SL-60	6.91
2-5/16	2-15/16	SL-76	7.63
3-3/16	3-3/4	SL-94	13.56
3-7/16	3-13/16	400	15.82
4	4-3/8	463	15.82
4-1/2	5-1/8	525	22.22
4-11/16	5-1/8	550	22.22
5-1/2	5-15/16	600	23.33
6-1/8	6-7/8	675	26.30
6-7/8	7-3/8	769	32.52
7-3/8	8	818	50.99
8-1/4	8-7/8	875	45.65
8-15/16	9-3/4	988	48.93
9-5/16	11-3/8	1125	99.09
11-3/16	13	1275	112.76
13-3/16	15	1450	186.28
15-1/16	17-1/2	1700	227.08

SPIRAL CLAMPS (right hand a.k.a. clockwise)



Plated Steel

hose size	part number	list each
1-1/2	SC-150	12.31
2	SC-200	13.81
2-1/2	SC-250	16.29
3	SC-300	17.38
4	SC-400	19.32
5	SC-500	26.79
6	SC-600	26.32
8	SC-800	30.19
10	SC-1000	42.35
12	SC-1200	43.55